

LIQUIP 3" HOT AIR DRY BULK SWIVEL

Liquip's 3" Hot Air swivel has been custom engineered for use on dry bulk tankers. This lightweight swivel can be fitted between the hot air blower on the prime mover and the trailer liquification jet to remove torque forces on hoses transferring hot air. This swivel is not suitable for use with liquids.



DBS080 Dry Bulk Swivel shown

Key Features

- Automatic operation (once fitted), providing low friction 360° rotation around its axis.
- Hard anodised aluminium bodies to avoid threads seizing.
- Deep groove ball bearing fitted for higher load capacity and long life.
- Low friction PTFE seals able to withstand extreme temperatures.
- High temperature bearing grease ensuring suitability for up to 150°C.
- Installation tool (available separately) designed to match housing and ensure the swivel will achieve a tight fit.
- Grease nipple for regular maintenance and servicing.

Technical Information

Materials	Hard anodised aluminium body PTFE packing seals Steel deep groove ball bearing Zinc plated steel taptite torx screws
Weight	1.3kg
Mounting	3" Female BSPT thread and 3" Male BSPT thread DBS080-TOOL (available separately) uses machined flats on both ends for tight fitting
Dimensions	Less than 150mm diameter x 119mm overall length
Bore	Minimum Ø68 bore
Temperature	Temperature tested up to 150°C
Adjustment or Service	Periodically grease with high temperature bearing grease. Swivel can be disassembled to inspect and replace low-friction PTFE seals or bearing if necessary.
Dismantle	Allow to cool and remove from installed location to workbench. Remove 4 outer screws and pull female threaded body in opposite direction. The inner seal is located inside the body. Remove 4 inner screws to separate tail retainer from male threaded tail. With mail thread upwards, push down on body retainer to slide bearing off the tail. The outer seal is located inside the body retainer. Reverse procedure to reassemble.

Ordering Information

- DBS080:** 3" Hot Air Swivel for Dry Bulk Discharge.
DBS080-TOOL: DBS080 installation tool.

Associated Equipment

- LM Series Hatches
 T-Series Hopper Tees
 Aeration Butterfly Valves
 VC0322 - 3" Check valves

DBS080 DRY BULK SWIVEL 3"

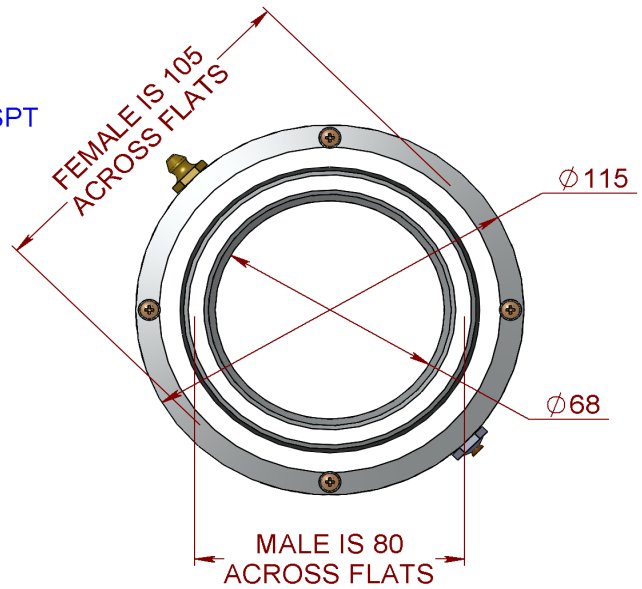
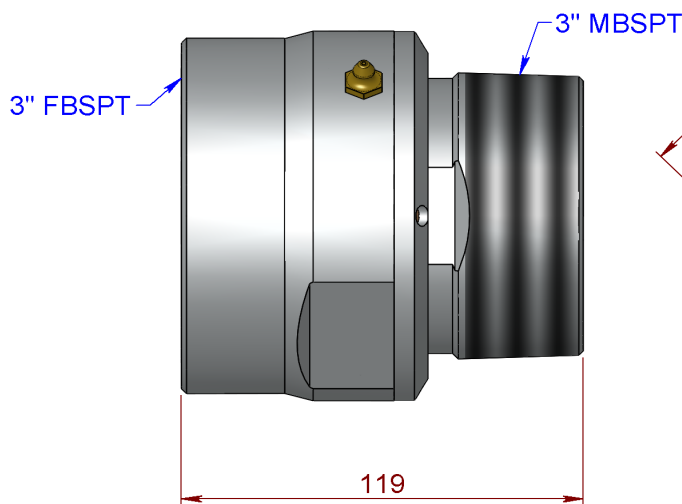

- HARD ANODISED ALUMINIUM BODIES.
- PTFE SEALS
- STEEL DEEP GROOVE BALL BEARING
- GREASING PORT
- 1.3kg



INSTALLATION TOOL
(ORDER SEPARATELY)

METERS - VALVES - VENTS - MANHOLES - HOSEREELS - OVERFILL PROTECTION - LOADING ARMS - ELECTRONIC DIPSTICKS